



HVNSleep Mask
User Manual

Contents

1	HVNSleep Mask	03
2	Power On/Off Instructions	05
3	Battery Instructions	06
4	Bluetooth Connection and Data Syncing	07
5	Wearing and Cleaning Instructions	08
6	App Instructions	10
7	Precautions	11
8	FCC Statement	12

1. HVNSleep Mask

This smart anti-snoring eye mask is designed to accurately detect snores and promote sleep by emitting tiny vibrations. We hope this product will help you get some quality sleep!

Product parameters

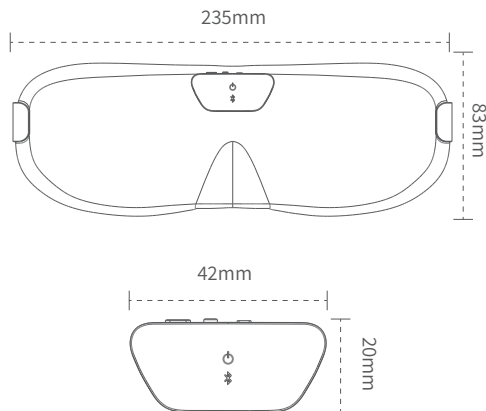

Weight: Approx. 38g

Overview

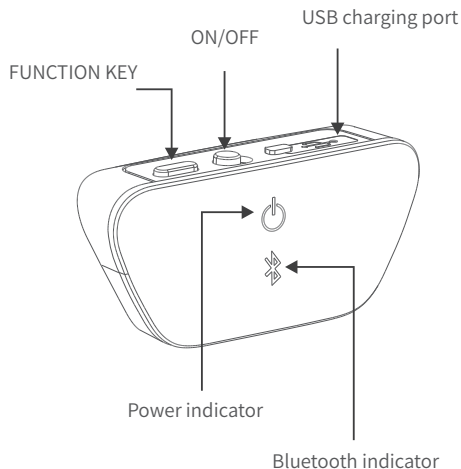

Accessories

Eye Mask x1
User Manual x1
Charging Cable x1

2. Power On/Off Instructions

Power on

To turn the device on, simply toggle the power switch to ON.

Once powered on, the power indicator will turn on for 15 seconds and the Bluetooth indicator will flash for 15 seconds before turning off.

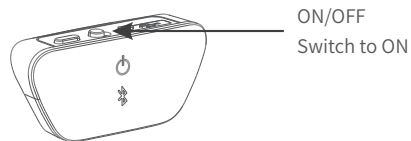

Power off

To turn off the device, toggle the power switch to OFF. The power and Bluetooth indicators will turn off once the device is successfully powered off.

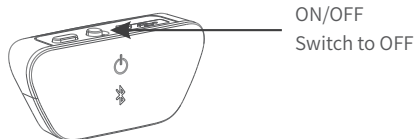

3. Battery Instructions

Checking the battery level

You can determine the battery by checking the color of the power indicator.

A red power light indicates the device has low battery and requires charging.



A green power light indicates the device has sufficient battery and does not require charging.



To check the specific battery level, connect the device to the Sleepplus app and view from your phone.

2018-09-21 08:22  75%

- (1) This device uses a rechargeable polymer lithium battery.
- (2) It takes roughly two hours to fully charge the battery after which it can last for approximately two nights.

- (3) The power indicator will flash when the device is plugged in to charge. A red flashing light indicates low battery while a green flashing light indicates the device is almost fully charged. The green light will stay on when it is fully charged. The device will automatically turn off once unplugged.

4. Bluetooth Connection and DataSyncing

- (1) The device can only be found and connected to the mobile app when the Bluetooth indicator is flashing. Toggle the power switch to ON or press the Function Key. The Bluetooth indicator will flash for 15 seconds and will turn off if no phone is connected.
- (2) Ensure your phone's Bluetooth is turned on.
- (3) Open the Sleepplus mobile app and ensure your phone is close to the device. Follow the instructions on the app to bind and connect the device. The connection is successful if the Bluetooth indicator stops flashing but remains lit.
- (4) Only iPhones with iOS 7.0 or above or Android phones running 4.3 or above are supported. If your phone is Android 7.0 or above, please enable the Location function to connect to the device and sync data.

5. Wearing and Cleaning

- (1) After powering on the device, please refer to the image below on how to wear it. Ensure the main electronic component is close to your forehead. The elastic strap can be placed directly over your ears.

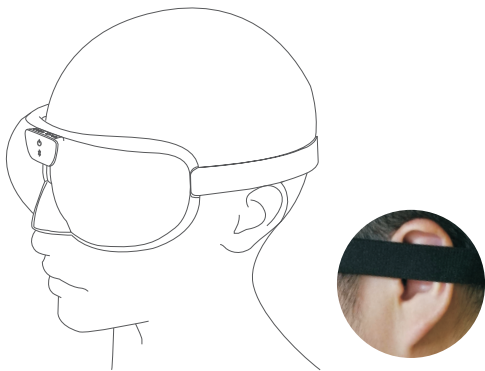

- (2) The main electronic part of this device is not waterproof. Please make sure to remove it before washing the eye mask. If choosing to machine wash, please put the eye mask in a mesh laundry bag to prevent damage. It is recommended to use a wet tissue to clean the device.

- (3) How to remove the electronic component: Hold the eye mask firmly with one hand, placing your thumb below the electronic component while firmly holding the component base on the back with your fingers, as shown below. Use your other hand to separate the electronic component and gently remove it from the mask.



- (4) How to install the electronic component: Align the electronic component with the corresponding slot and press down to install in place.

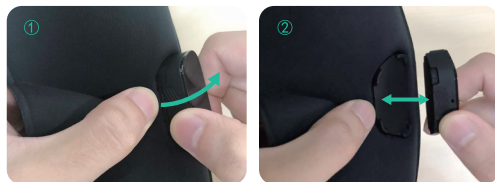

6. App Instructions

How to download:

- (1) iPhone: Search for Sleepplus via the App Store to download and install the app.
- (2) Android: Search for Sleepplus in Google Play to download and install the app.
- (3) Scan the QR code below.

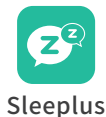

7. Precautions

- (1) Use and store the device in a normal temperature range (-10°C to +50°C) or (14°F to 122°F) .
- (2) Keep the device away from sources of ignition or high temperatures (electric heaters, microwaves, ovens, etc.).
- (3) Keep the device away from high impact or strong vibration to avoid damage.
- (4) Do not use chemicals, detergents or other products to clean the device. Keep the device dry and do not wash the electronic component.
- (5) Do not attempt to remove or replace the built-in lithium battery on your own so as to avoid damage.
- (6) Do not throw the device into fire so as to prevent the possibility of an explosion.
- (7) This device is not a toy. Please keep it out of the reach of children to prevent misuse or other hazards from occurring.

8. FCC Statement

This device complies with part 15 of the FCC rules. Operation is subject to the following two conditions: (1) this device may not cause harmful interference, and (2) this device must accept any interference received, including interference that may cause undesired operation.

Changes or modifications not expressly approved by the party responsible for compliance could void the user's authority to operate the equipment.

NOTE: This equipment has been tested and found to comply with the limits for a Class B digital device, pursuant to part 15 of the FCC Rules. These limits are designed to provide reasonable protection against harmful interference in a residential installation. This equipment generates uses and can radiate radio frequency energy and, if not installed and used in accordance with the instructions, may cause harmful interference to radio communications. However, there is no guarantee that interference will not occur in a particular installation. If this equipment does cause

harmful interference to radio or television reception, which can be determined by turning the equipment off and on, the user is encouraged to try to correct the interference by one or more of the following measures:

- Reorient or relocate the receiving antenna.
- Increase the separation between the equipment and receiver.
- Connect the equipment into an outlet on a circuit different from that to which the receiver is connected.
- Consult the dealer or an experienced radio/TV technician for help.

The device has been evaluated to meet general RF exposure requirement. The device can be used in portable exposure condition without restriction.